

iTrack Pro Series

TL26-20

Reflector

Technical Parameters:

Name	Parameters
Light source:	COB
Input Voltage:	AC220~240V 50/60Hz
LED Current:	500mA, 35-37V
Rated life:	>35,000 hours
Operating temperature:	-20°C~40°C
Storage temperature:	-30°C~60°C
Certificate:	CE/RoHS
Weight:	0.95KG

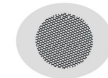
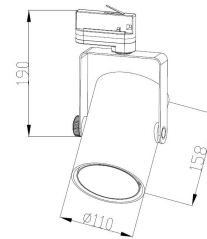

TL-PRO-05

TL-PRO-07

Ordering Information:

○ White ● Black

Power	CRI	Beam Angle	Luminous	CCT	Housing	Part Number	
20W	>80	▲ 10°	2040 lm	3000K	○	TL264-20W-830-W-10	
					●	TL264-20W-830-B-10	
		2050 lm	4000K	○	TL264-20W-840-W-10		
				●	TL264-20W-840-B-10		
		▲ 20°	2060 lm	3000K	○	TL264-20W-830-W-20	
			2060 lm	4000K	○	TL264-20W-840-W-20	
			●	TL264-20W-840-B-20			
	▲ 38°	2050 lm	3000K	○	TL264-20W-830-W-38		
		2040 lm	4000K	○	TL264-20W-840-W-38		
			●	TL264-20W-840-B-38			
	>90	>80	▲ 10°	1730 lm	3000K	○	TL264-20W-930-W-10
						●	TL264-20W-930-B-10
1870 lm			4000K	○	TL264-20W-940-W-10		
				●	TL264-20W-940-B-10		
▲ 20°			1750 lm	3000K	○	TL264-20W-930-W-20	
			1900 lm	4000K	○	TL264-20W-940-W-20	
			●	TL264-20W-940-B-20			
▲ 38°		1750 lm	3000K	○	TL264-20W-930-W-38		
		1890 lm	4000K	○	TL264-20W-940-W-38		
			●	TL264-20W-940-B-38			

Technical Data test pattern

CRI80 10°

3000K

4000K

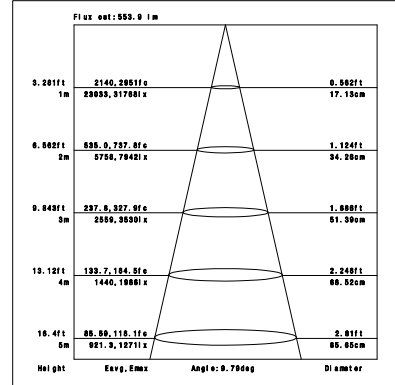
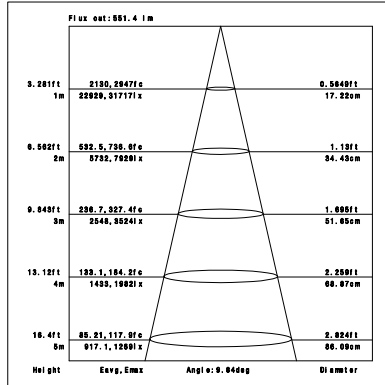
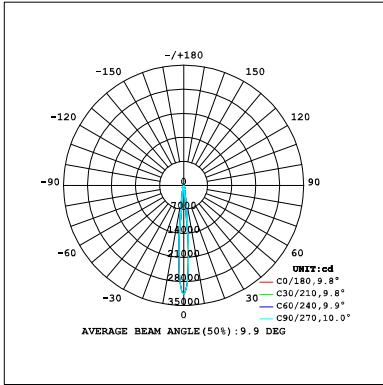

CRI80 20°

3000K

4000K

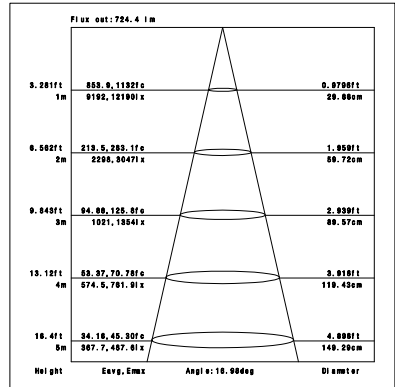
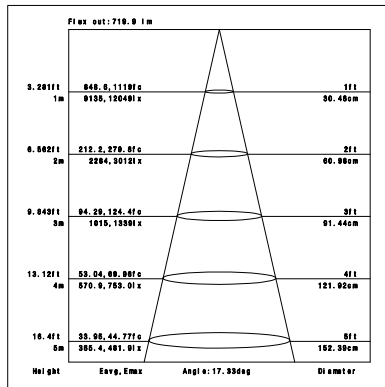
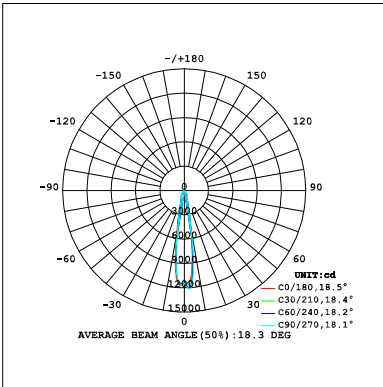

CRI80 38°

3000K

4000K

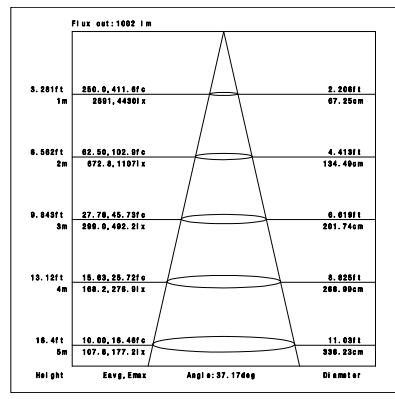
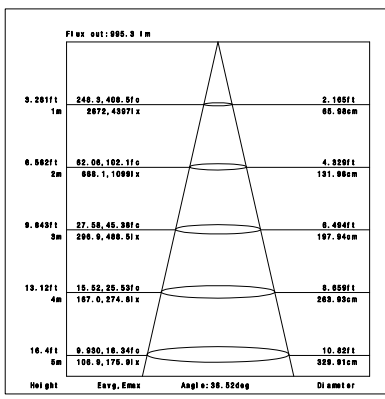
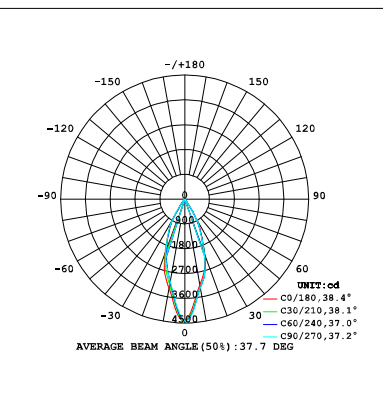

CRI90 10°

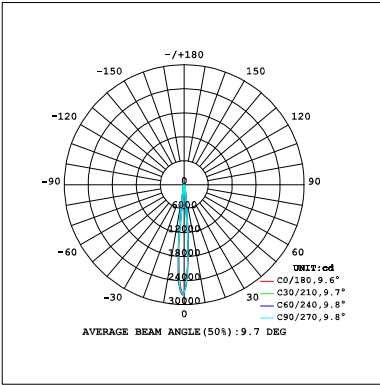

3000K

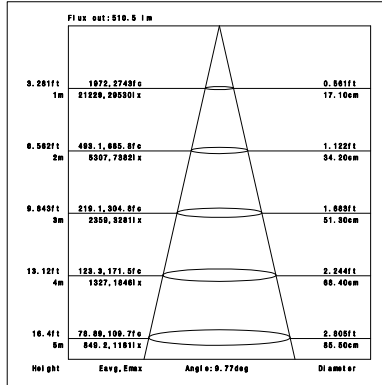

4000K

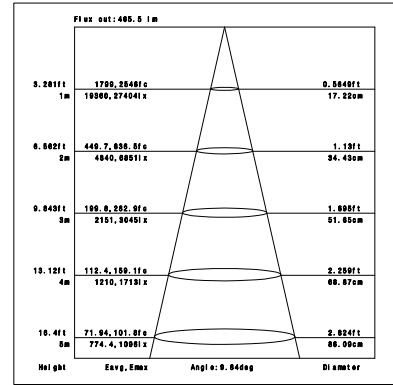

CRI90 20°

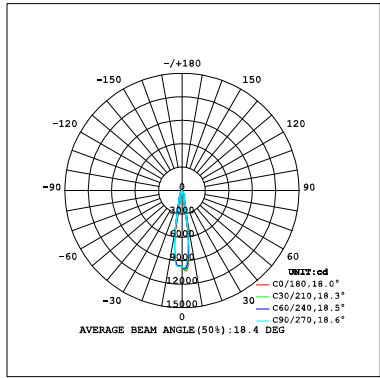

3000K

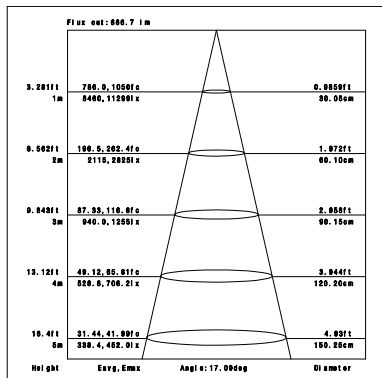

4000K

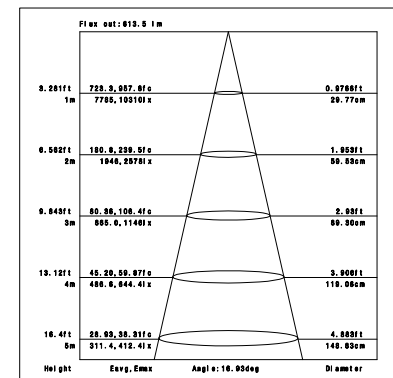

CRI90 38°

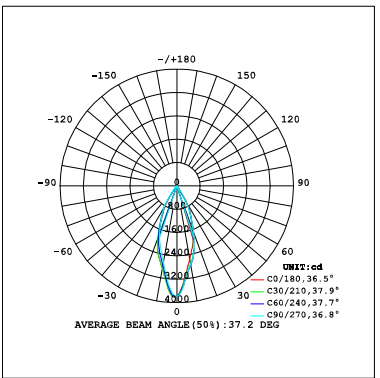

3000K

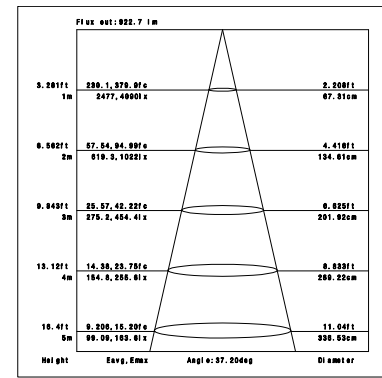

4000K

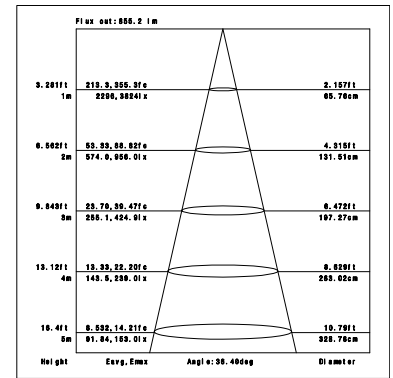

Installation instruction

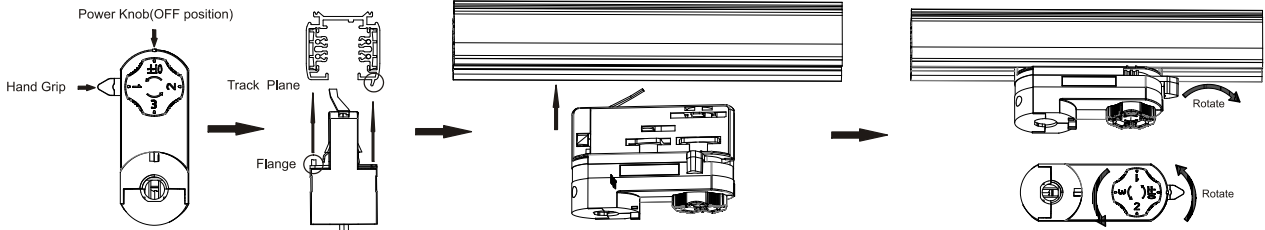

1. Make sure the positions are exactly the same as the pictures show before installation.
2. The adaptor flange is in the same direction with the track plane.
3. Track adaptor into the track
4. Revolve the hand grip in place, select the power knob: phase 1/phase 2/ phase 3. Can swing clockwise and anticlockwise.

Remove Instructions

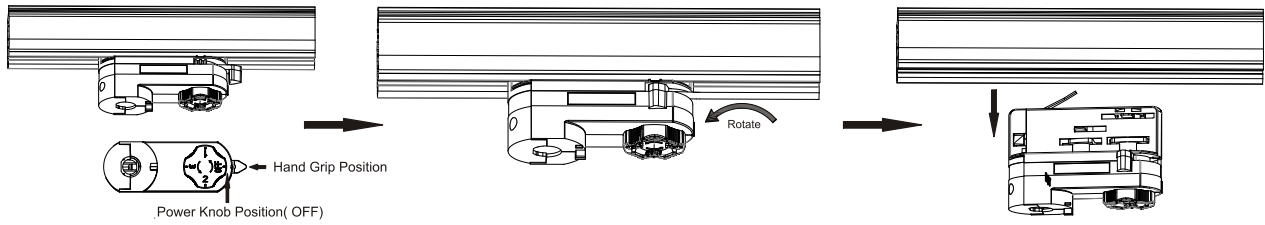

1. Make sure the track adaptor's positions are the same as the picture shows before removing.
2. When power knob at the "OFF" position, rotate the hand grip at 90 degree.
3. Remove the track adaptor.

Cautions

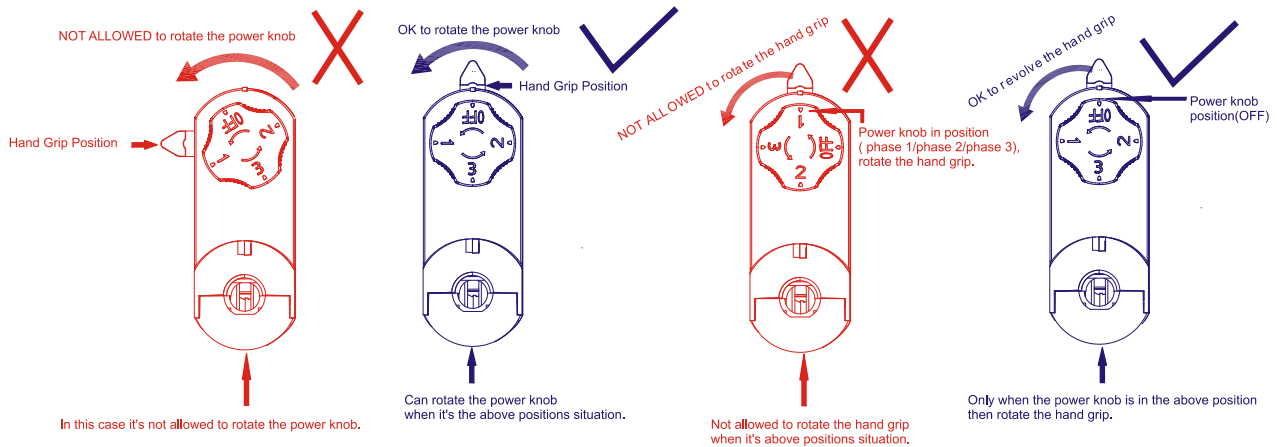

(Before Installation)

(Before Remove)

Packaging:

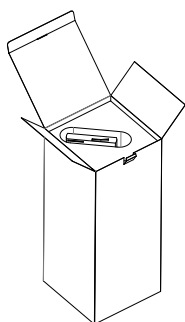

Box
L130*W130*H310mm
1pc/box
GW: 1.15kg/box

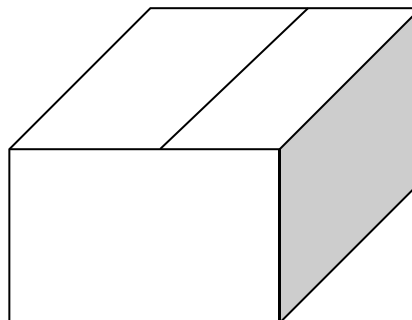

Outer carton
L670*W405*H325mm
15pcs/CTN
GW: 19kg/carton

Product naming system

